

FRONT DOOR CLOSED - LOW PROFILE

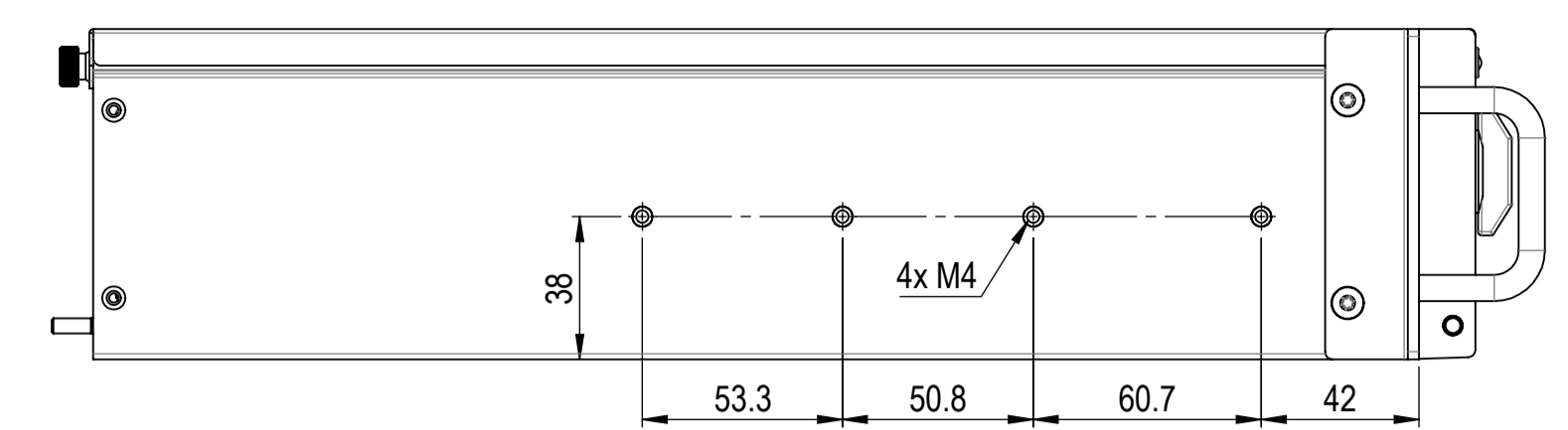

BACK VIEW

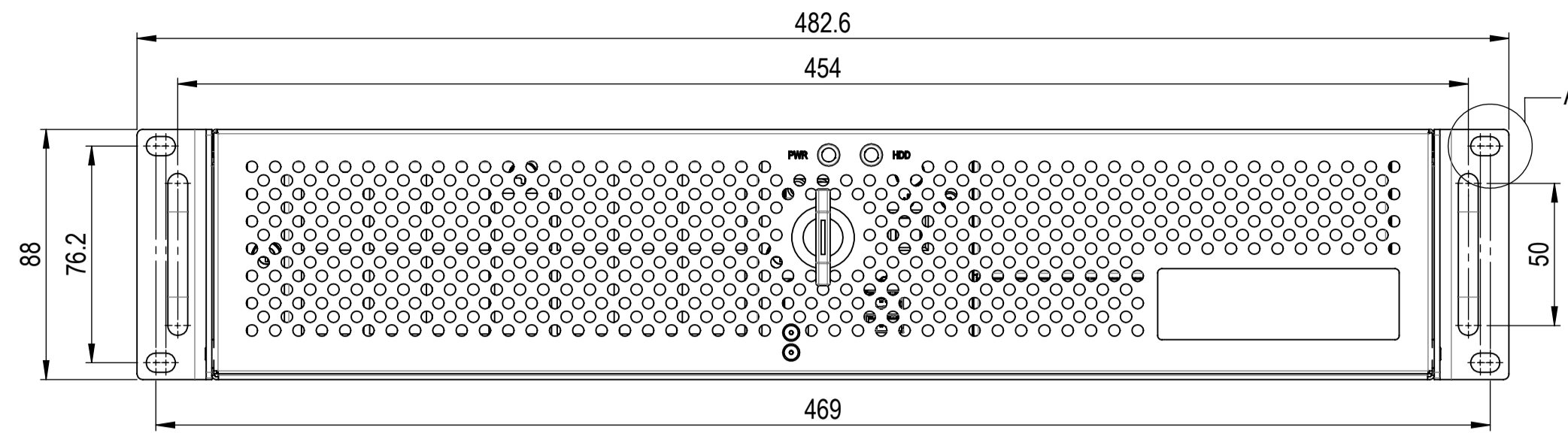
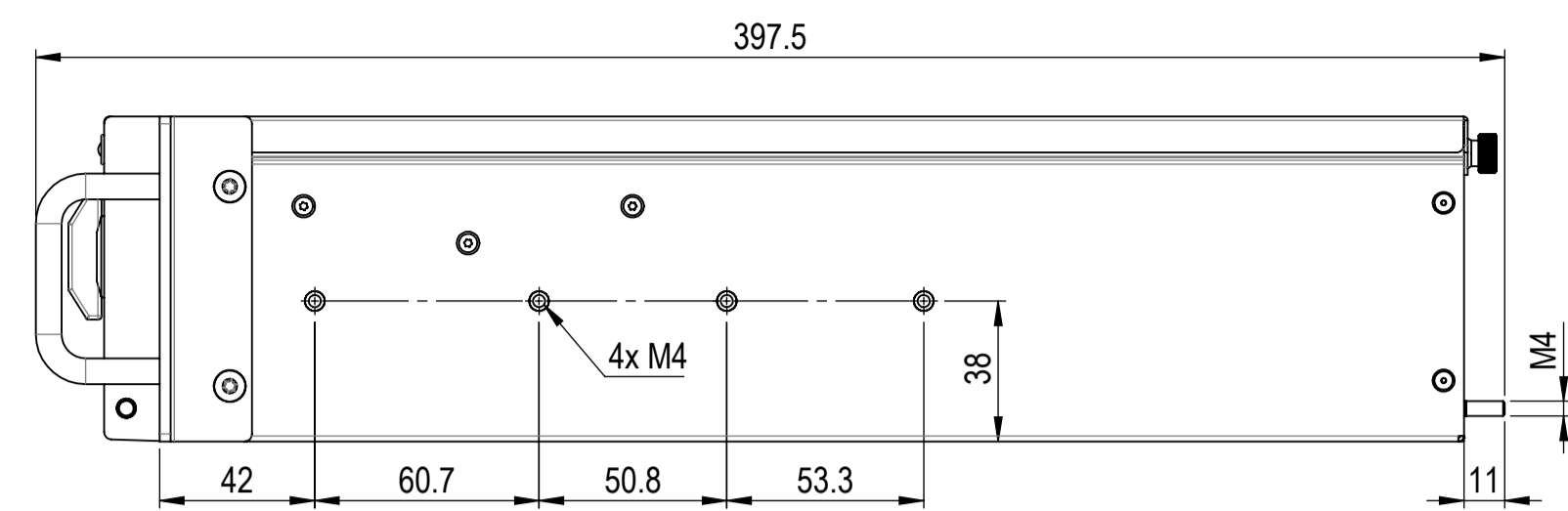
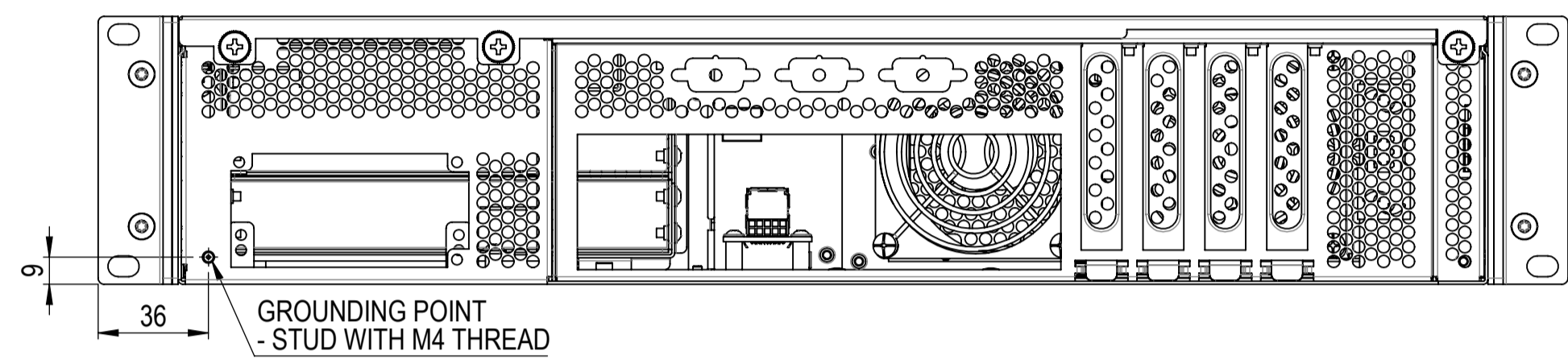

DETAIL A  
SCALE 2:1

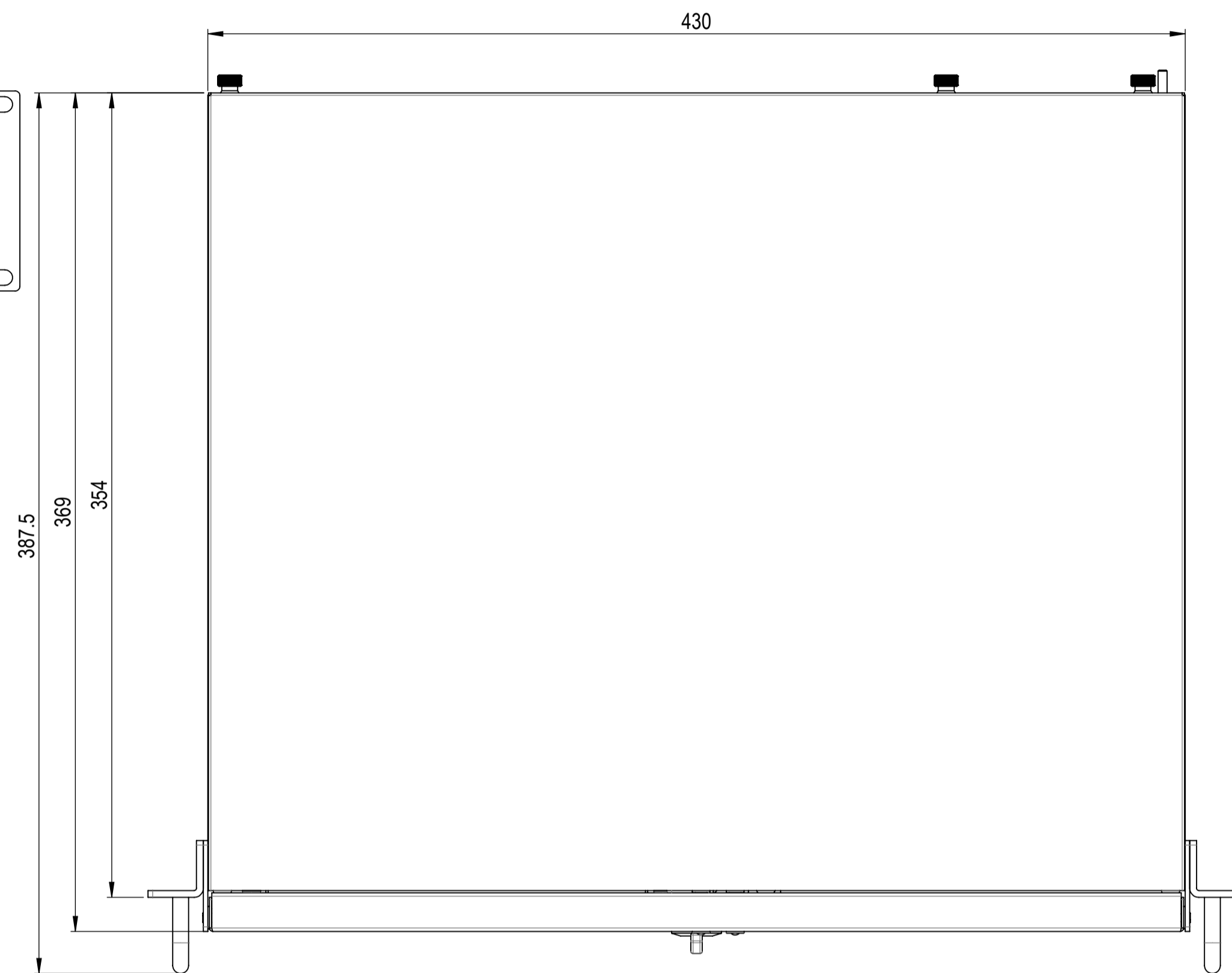
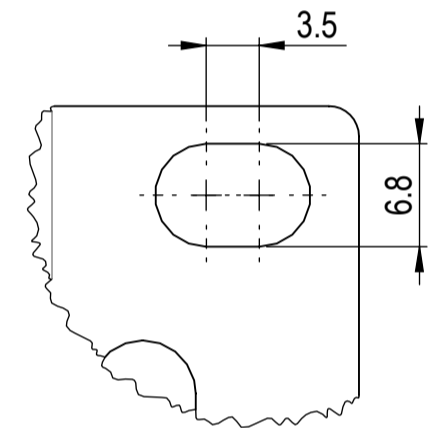

BOTTOM VIEW

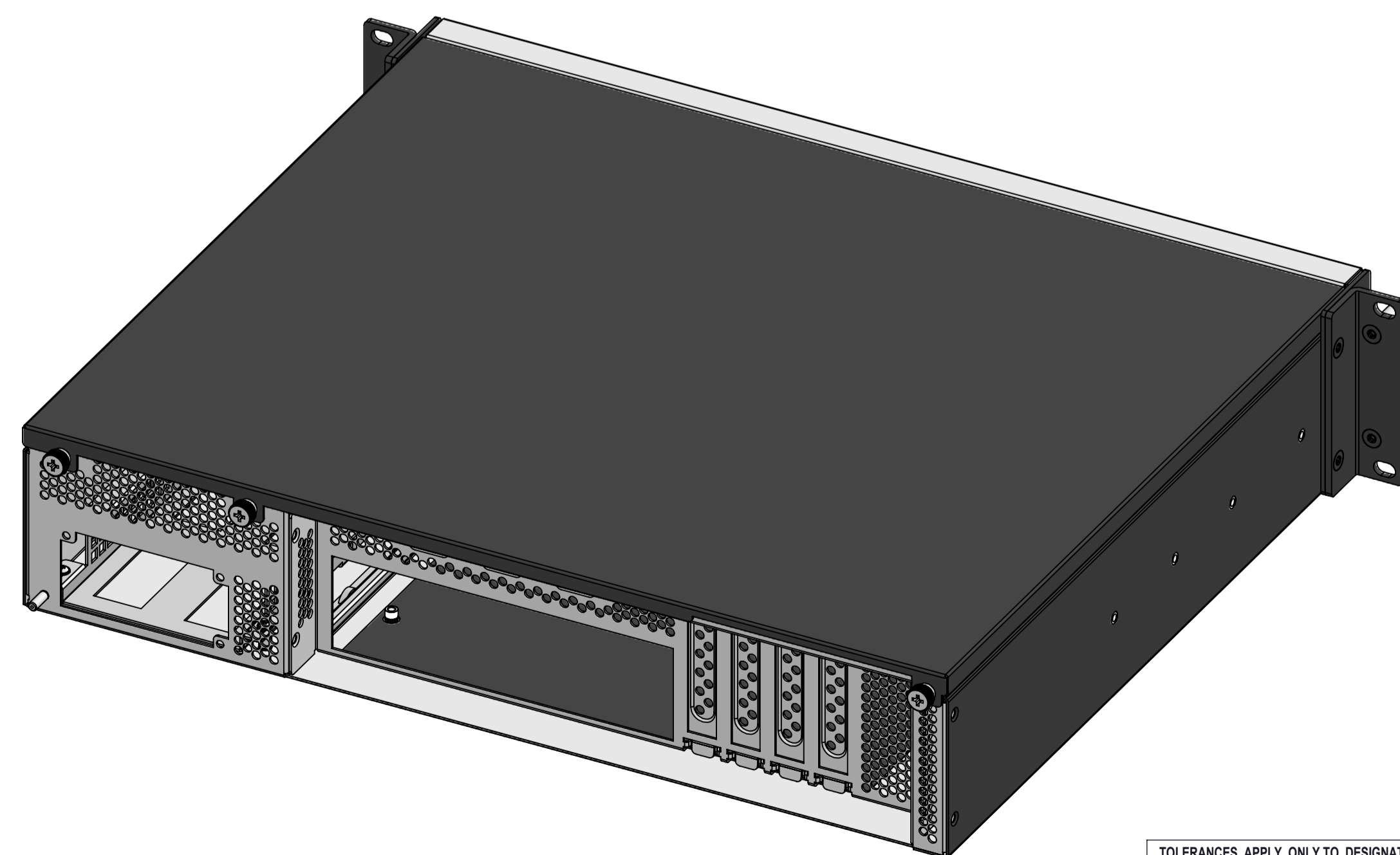
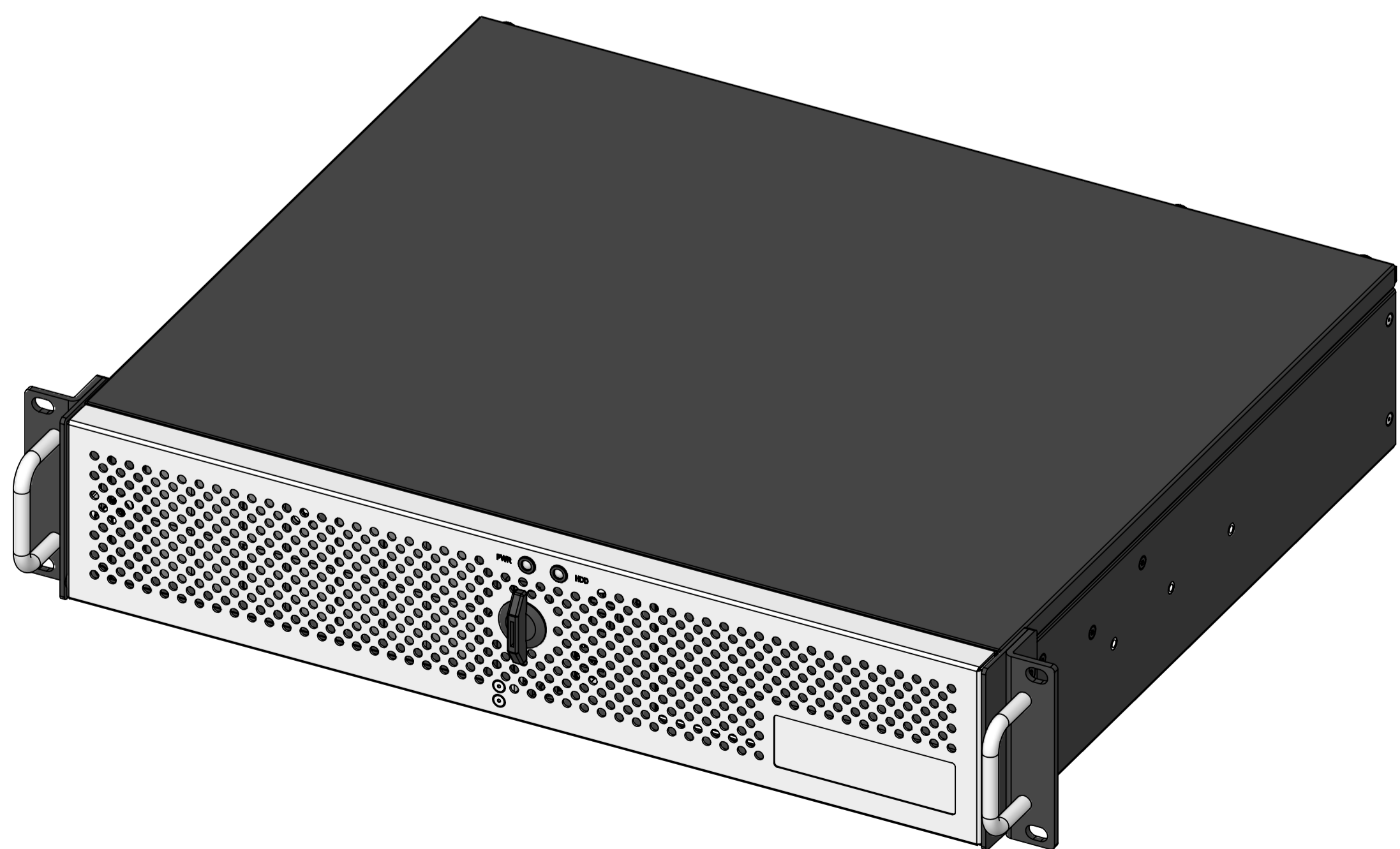
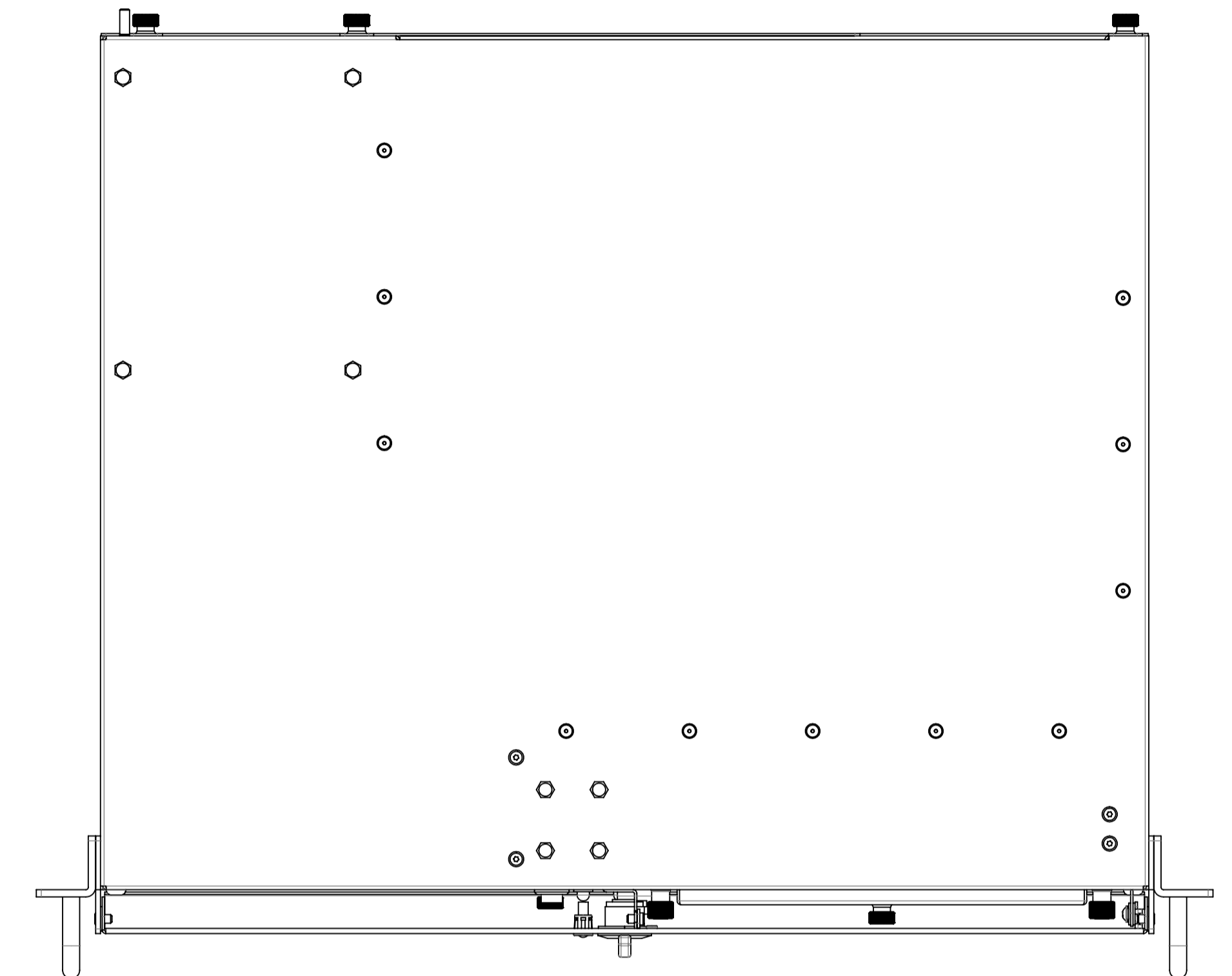

General:  
 Undimensioned shape according to 3D model.  
 Surface in visible area must be scratches free.  
 Normal Handling should be free from risk of injury.  
 Following specifications must be considered:  
 - Technical Procurement Specification Mechanics  
 - KISS ZU SHORT V3 Cosmetic Specification

TOLERANCES APPLY ONLY TO DESIGNATED DIMENSIONS, UNLESS OTHERWISE SPECIFIED:		DATE: 27.05.2019	TOLERANCES:	PART NO: 10141-099-01	PROJECT / CONTRACT NO: 65-01252
HOLE TO HOLE ±0.1mm	HOLE TO HOLE ±0.2mm	DRAWN: TOMAS PASZEK	SEE TABLE	MATERIAL/FINISH:	
HOLE TO HOLE ±0.1mm	EDGE TO HOLE ±0.2mm	DRAWN: TOMAS PASZEK		PART NAME: KISS ZU SHORT V3 CFL OUTLINE DRAWING	
EDGE TO HOLE ±0.1mm	EDGE TO EDGE ±0.2mm	APPROVED: TOMAS PASZEK		CONTRACT NUMBER: 10141-099-01	
EDGE TO EDGE ±0.2mm	HOLE SIZE ±0.08mm	DATE: 27.05.2019		REVISION: A	
HOLE SIZE ±0.08mm	BEND ANGLE ±85 DEG	DATE: 27.05.2019		SCALE: 1:1.2	
		DATE: 27.05.2019		SCALE: 1:1.2	
		DATE: 27.05.2019		SCALE: 1:1.2	

FRONT DOOR OPEN - LOW PROFILE

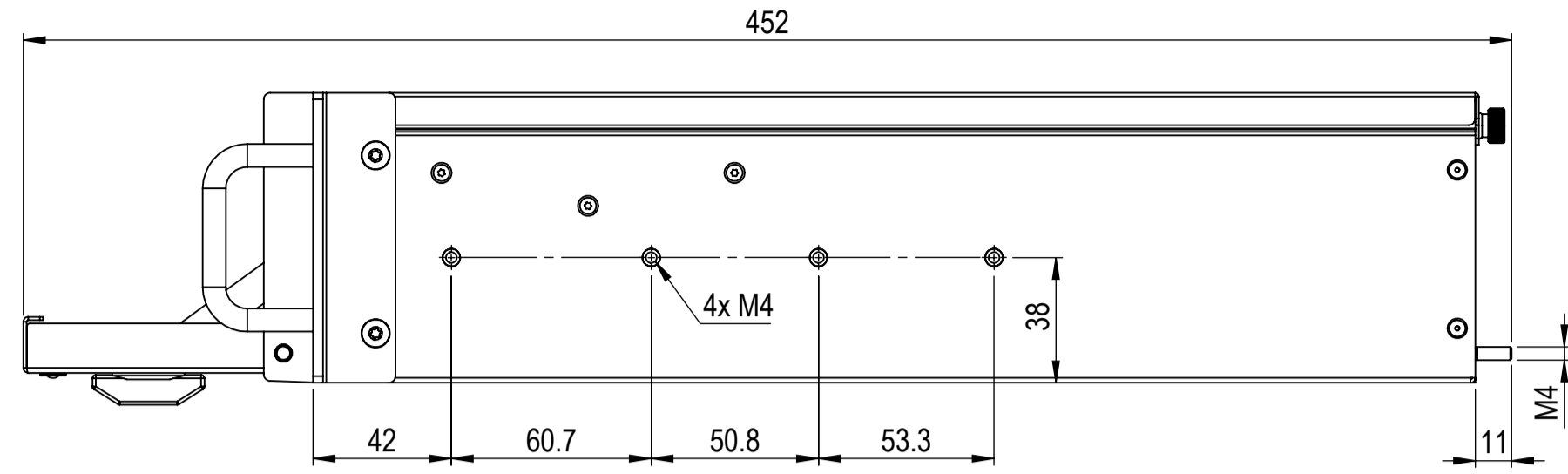

BACK VIEW

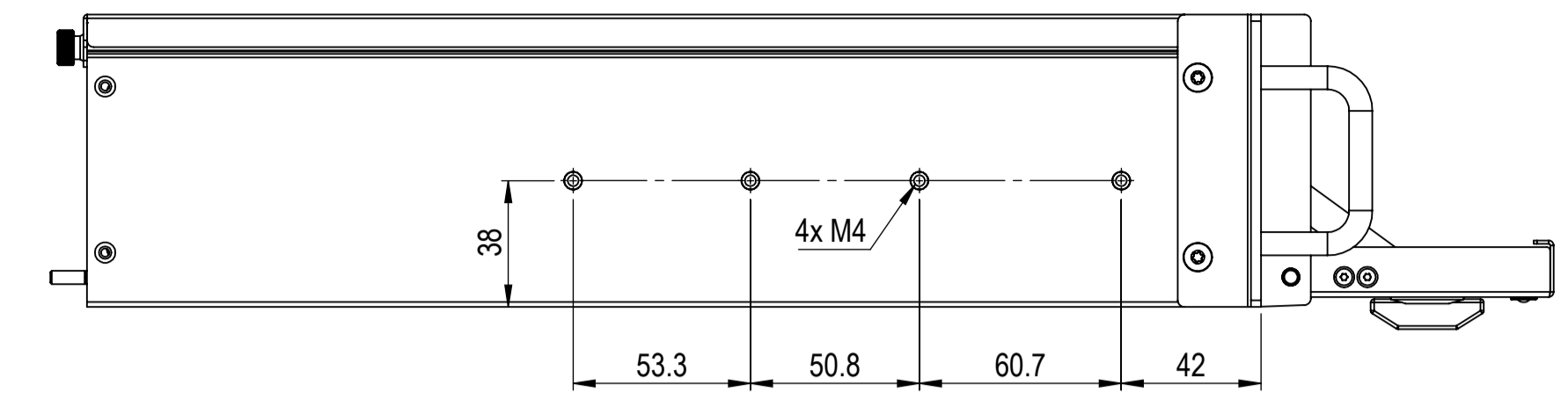
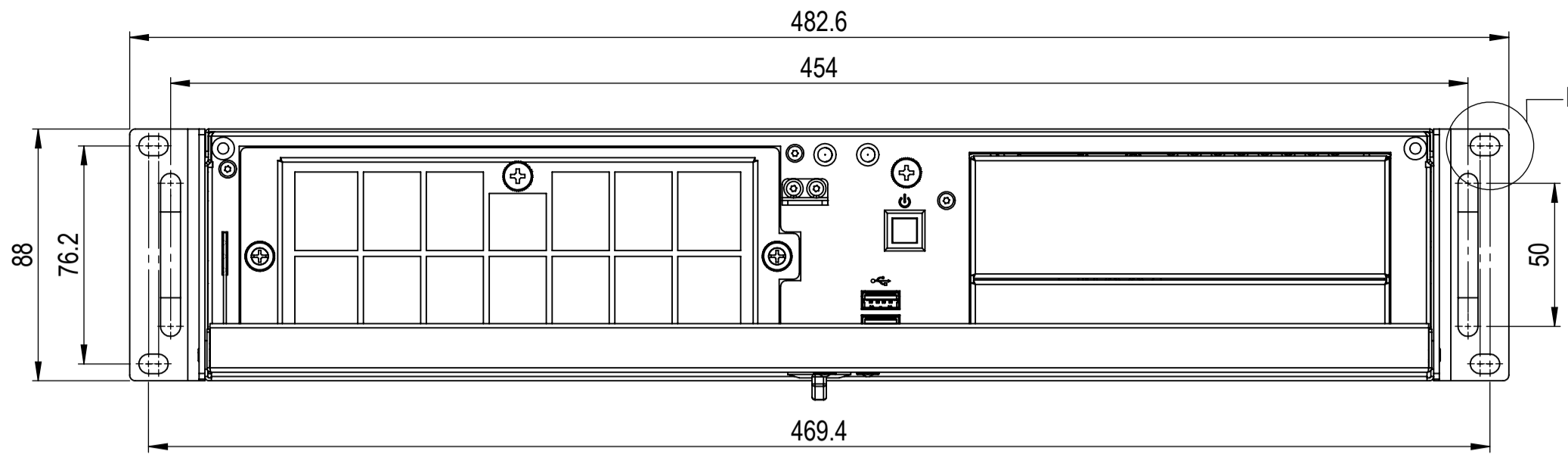

BOTTOM VIEW

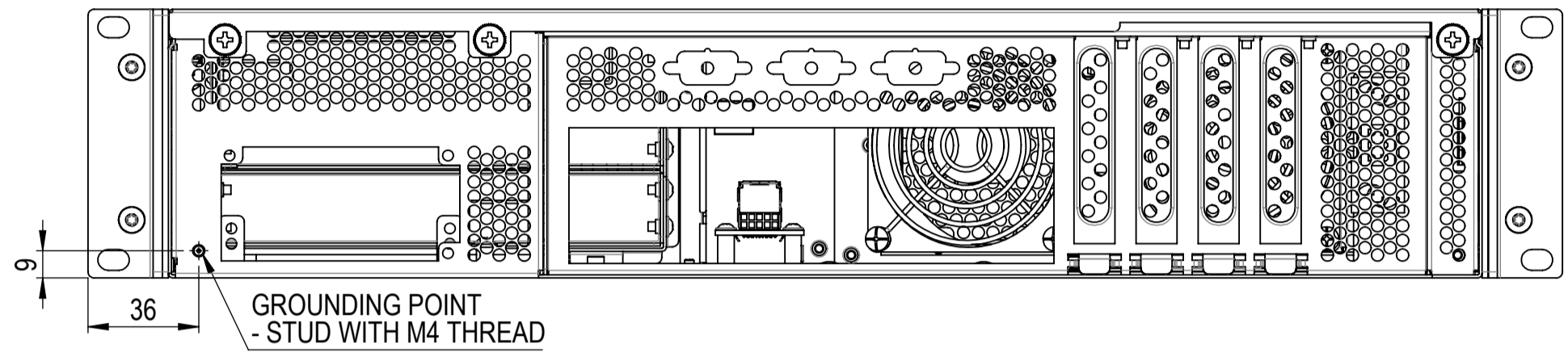

DETAIL B  
SCALE 2:1

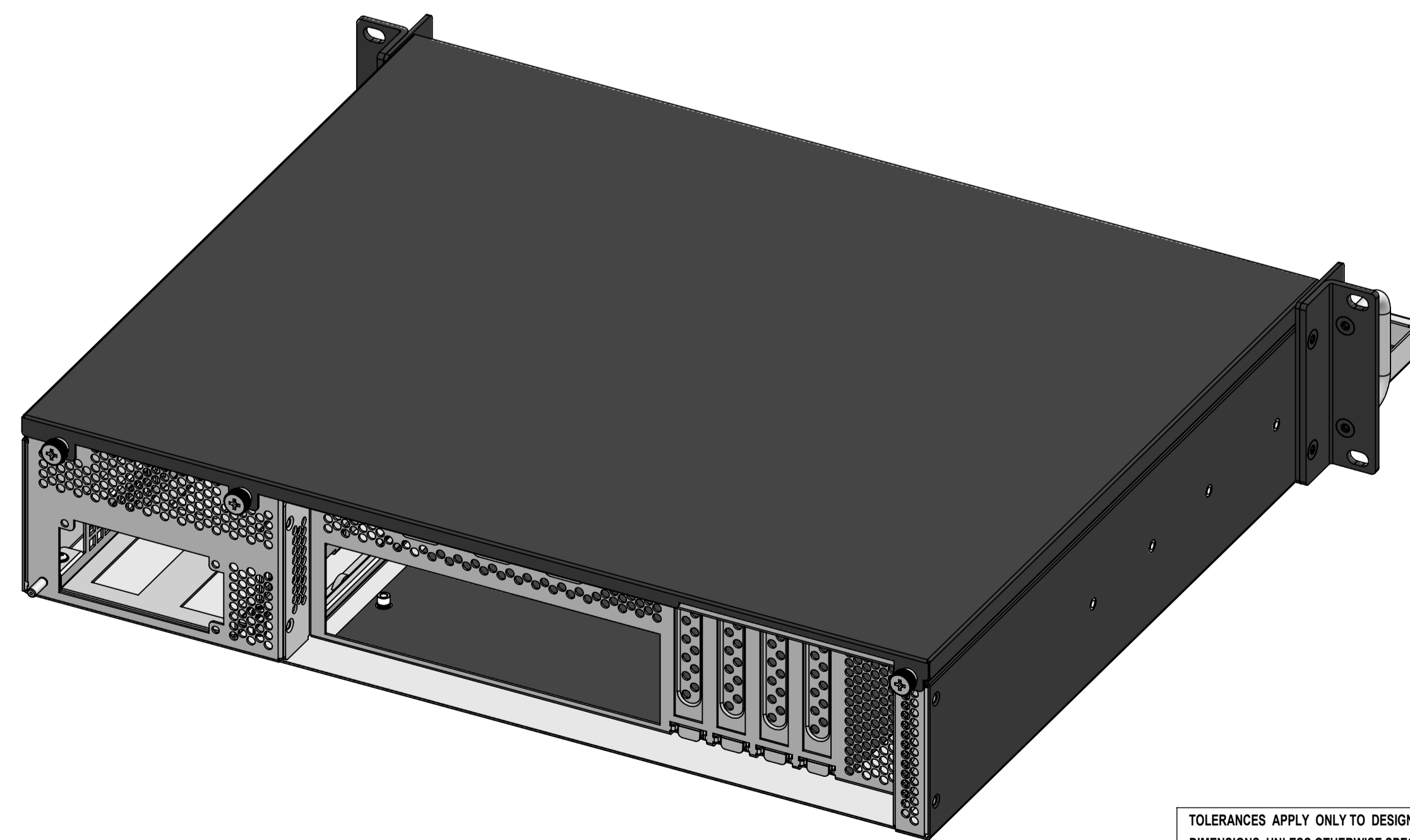
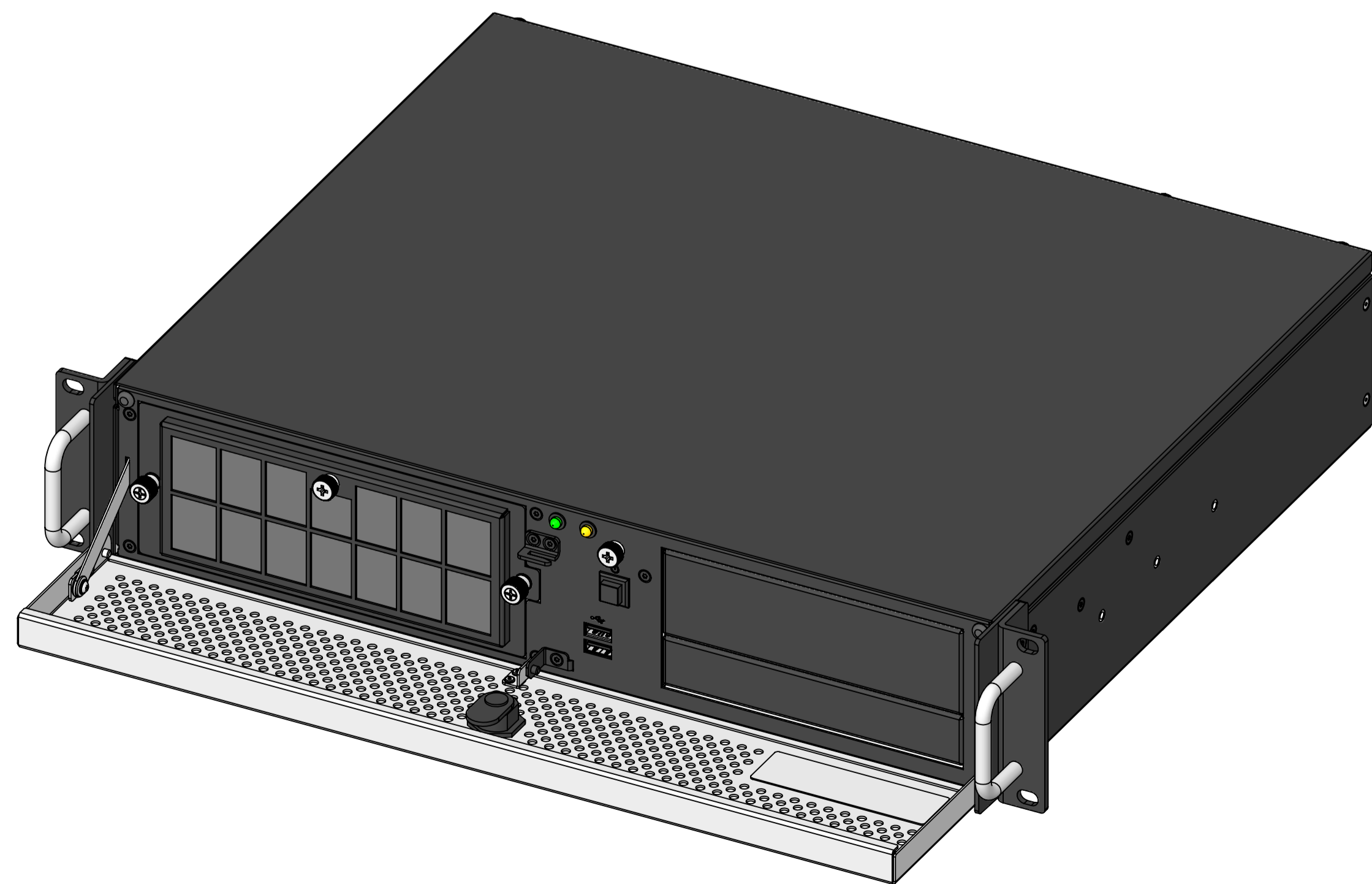
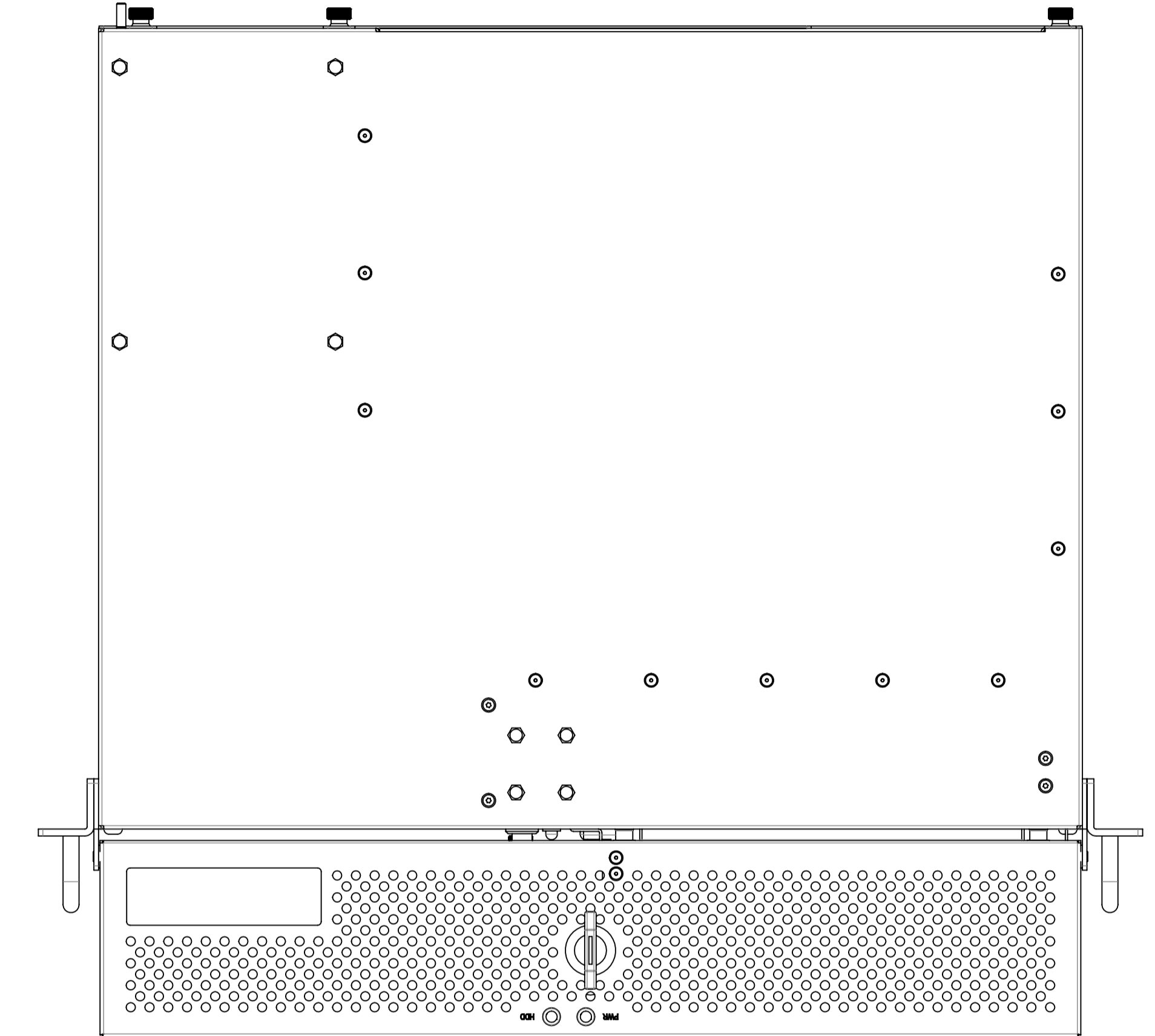
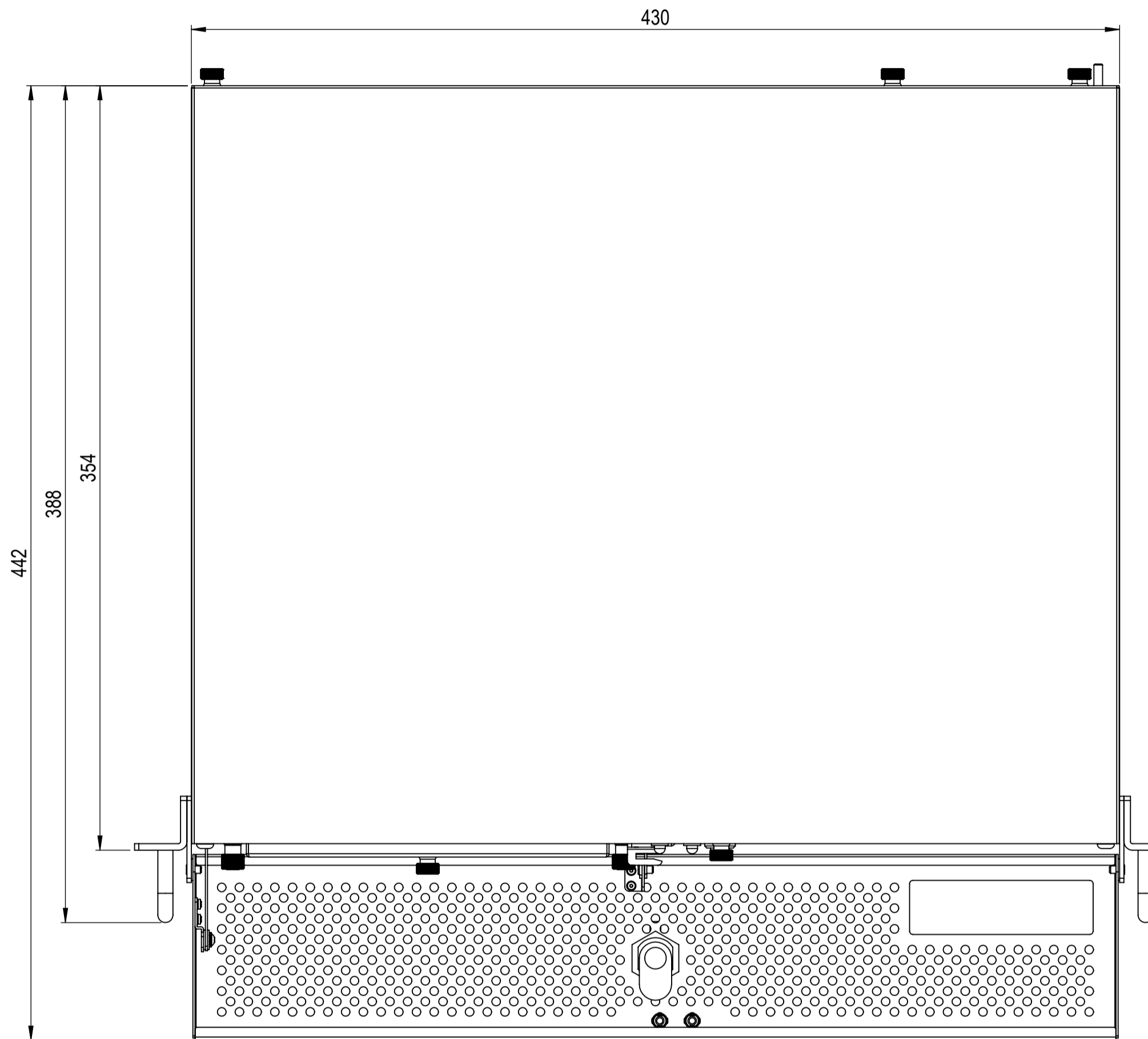
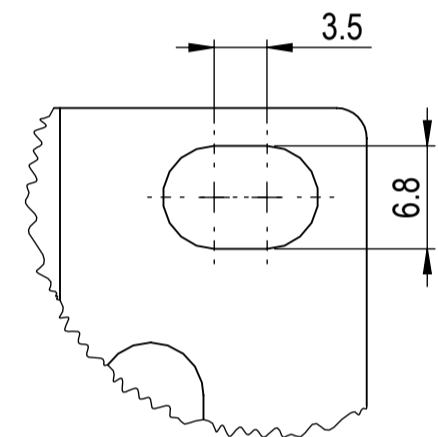

General:  
 Undimensioned shape according to 3D model.  
 Surface in visible area must be scratches free.  
 Normal Handling should be free from risk of injury.  
 Following specifications must be considered:  
 - Technical Procurement Specification Mechanics  
 - KISS 2U SHORT V3 Cosmetic Specification

TOLERANCES APPLY ONLY TO DESIGNATED DIMENSIONS, UNLESS OTHERWISE SPECIFIED:		DRAWN: 27.05.2019		TOLERANCES: 27.05.2019		PART NO: 10141-099-01		PROJECT / CONTRACT NO: 65-01252	
HOLE TO HOLE ±0.1mm	BEND TO HOLE ±0.2mm	DRAWN: TOMAS PASZEK		CHECKED: TOMAS PASZEK		MATERIAL/FINISH:		SEE TABLE	
HOLE TO HOLE ±0.1mm	BEND TO HOLE ±0.2mm	APPROVED: TOMAS PASZEK		APPROVED: TOMAS PASZEK		PART NAME: KISS 2U SHORT V3 CFL OUTLINE DRAWING		REVISION: A	
EDGE TO HOLE ±0.2mm	BEND TO EDGE ±0.2mm	DATE: 27.05.2019		DATE: 27.05.2019		PART NAME: KISS 2U SHORT V3 CFL OUTLINE DRAWING		REVISION: A	
EDGE TO HOLE ±0.2mm	BEND TO EDGE ±0.2mm	DATE: 27.05.2019		DATE: 27.05.2019		PART NAME: KISS 2U SHORT V3 CFL OUTLINE DRAWING		REVISION: A	
HOLE SIZE ±0.08mm	BEND ANGLE ±0.5 DEG	DATE: 27.05.2019		DATE: 27.05.2019		PART NAME: KISS 2U SHORT V3 CFL OUTLINE DRAWING		REVISION: A	
HOLE SIZE ±0.08mm	BEND ANGLE ±0.5 DEG	DATE: 27.05.2019		DATE: 27.05.2019		PART NAME: KISS 2U SHORT V3 CFL OUTLINE DRAWING		REVISION: A	



FRONT DOOR CLOSED - RISER CARD

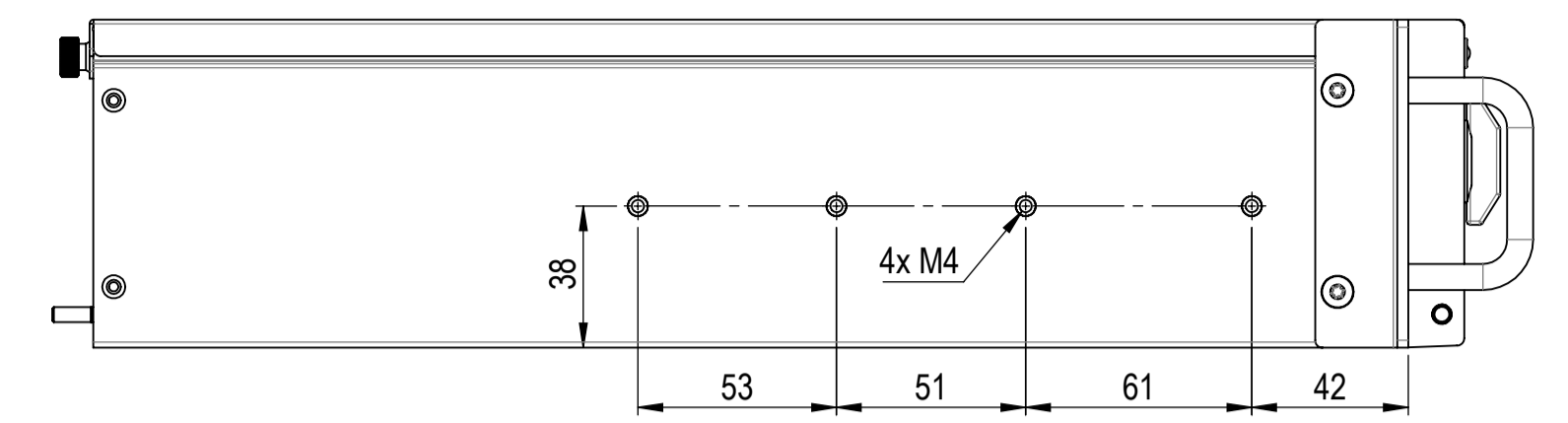
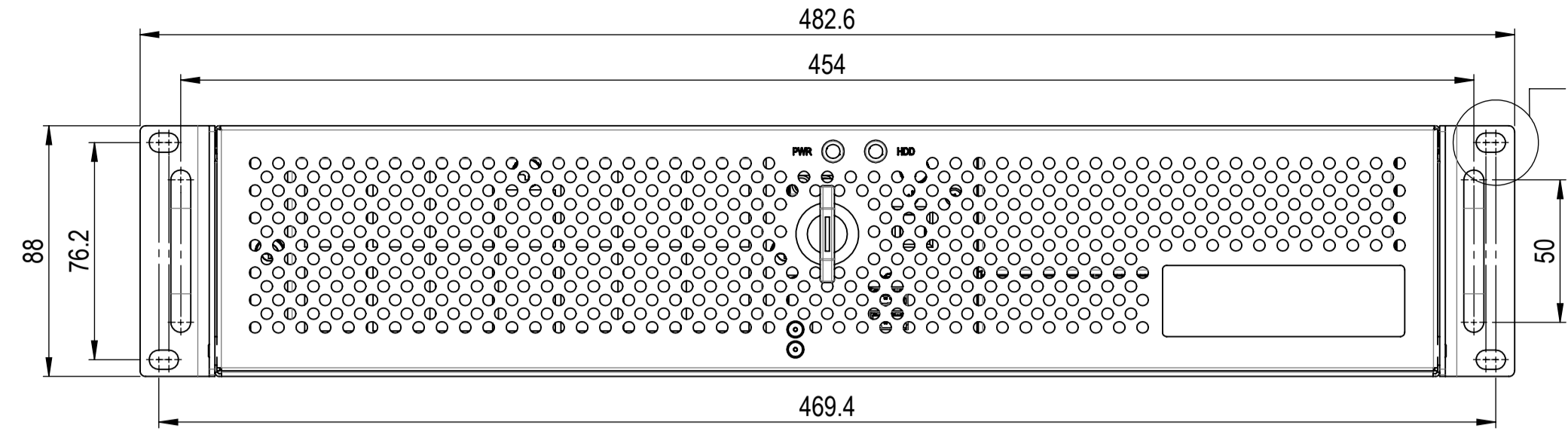
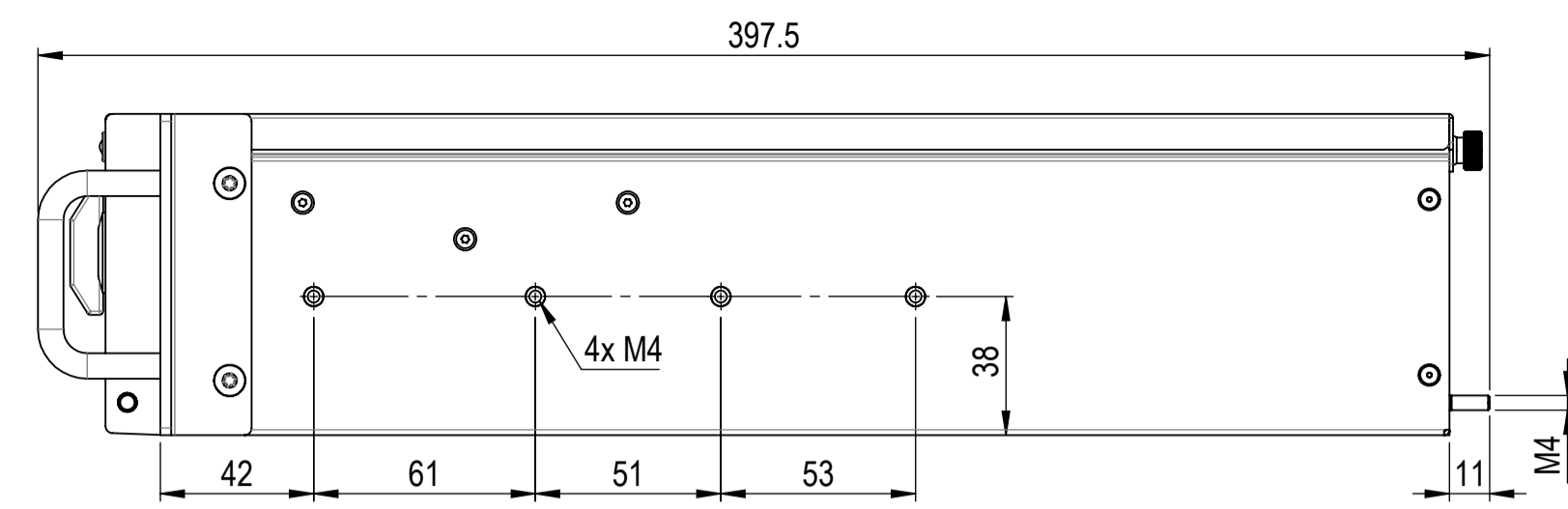

BACK VIEW

BOTTOM VIEW

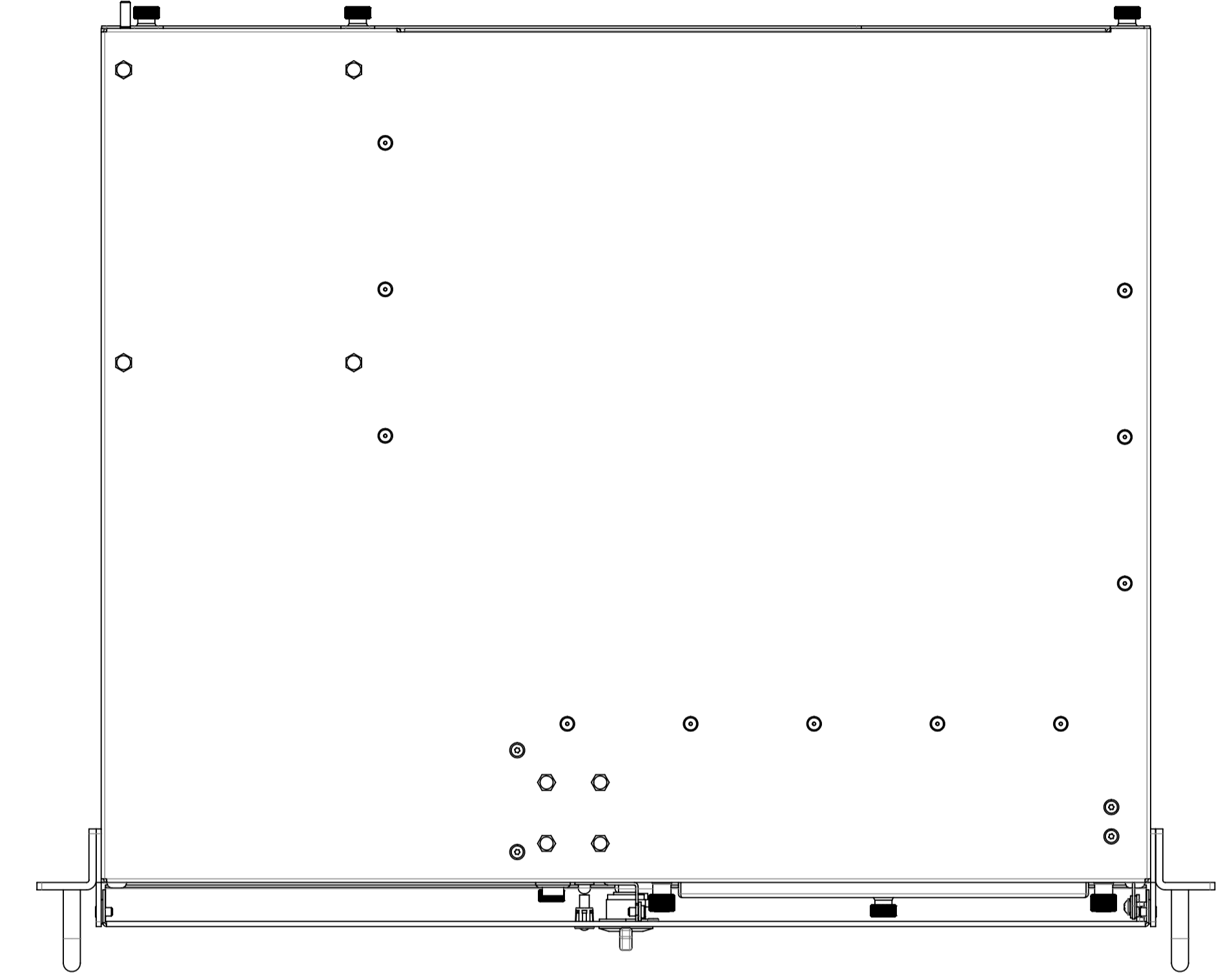
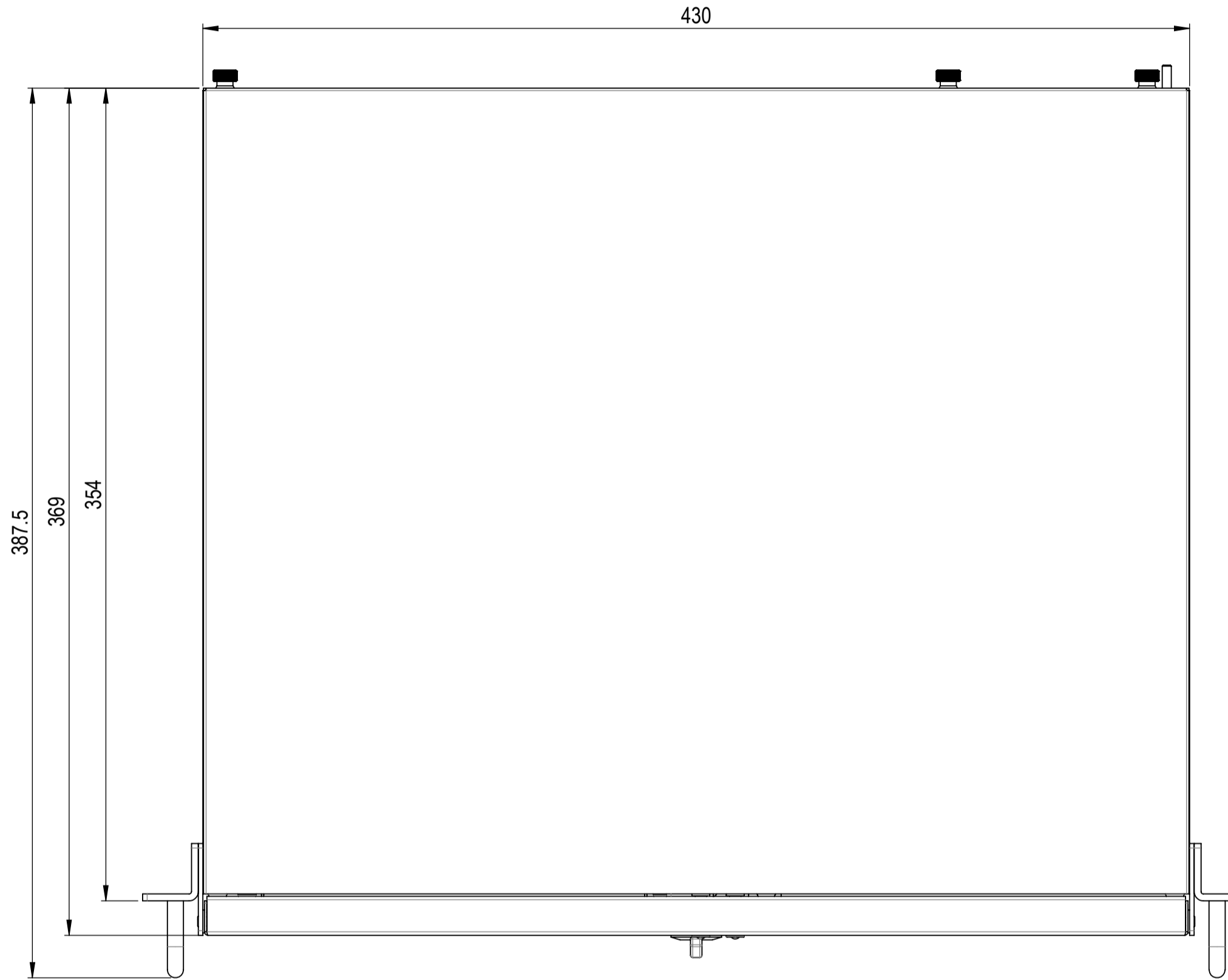
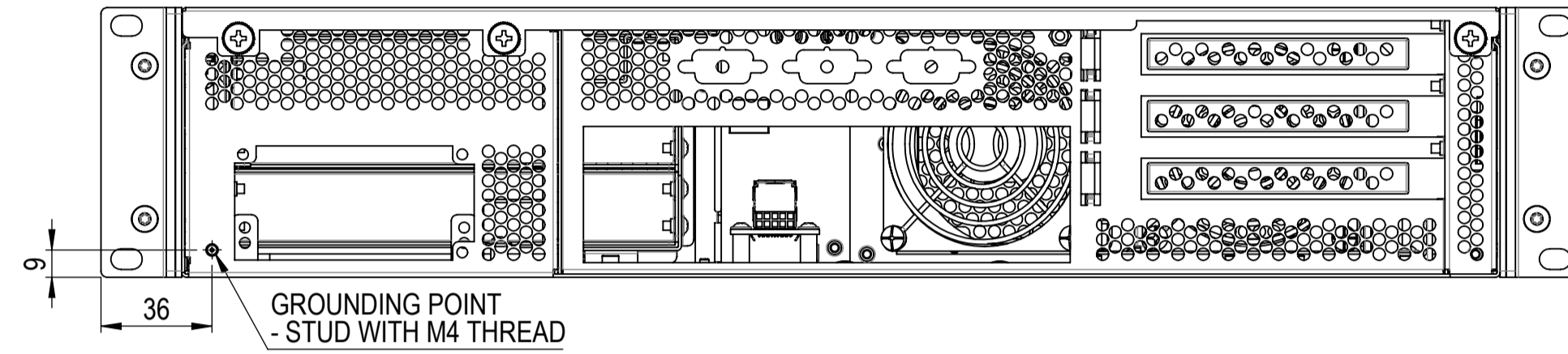

DETAIL C  
SCALE 2:1

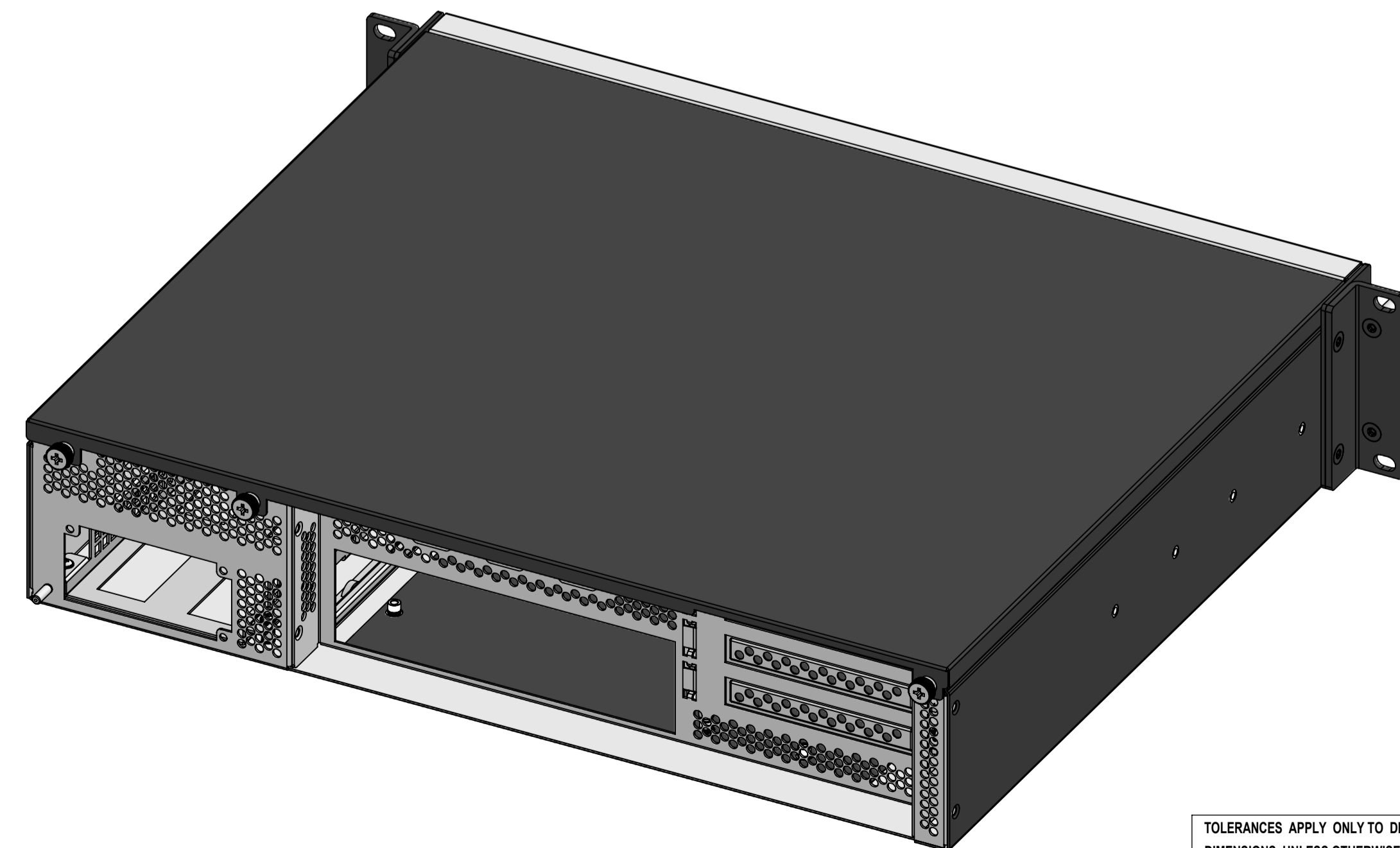
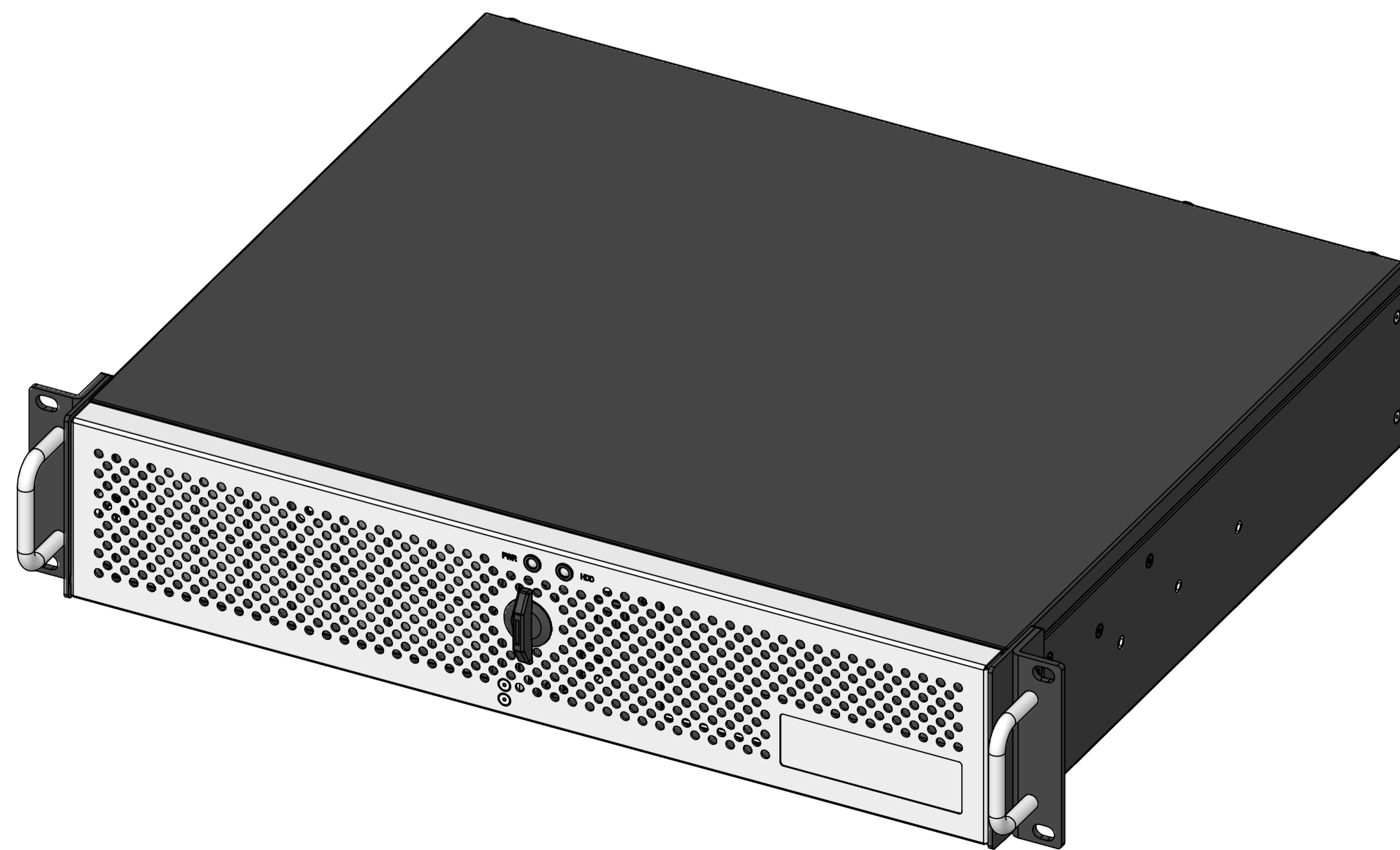
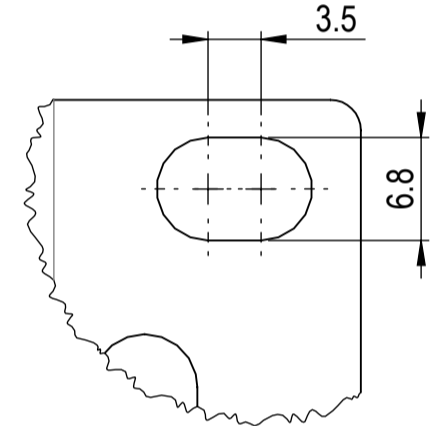

General:  
 Undimensioned shape according to 3D model.  
 Surface in visible area must be scratches free.  
 Normal Handling should be free from risk of injury.  
 Following specifications must be considered:  
 - Technical Procurement Specification Mechanics  
 - KISS 2U SHORT V3 Cosmetic Specification

TOLERANCES APPLY ONLY TO DESIGNATED DIMENSIONS, UNLESS OTHERWISE SPECIFIED:		DATE: 27.05.2019	DESIGNED BY: TOMAS PASZEK	DATE: 27.05.2019	APPROVED BY: TOMAS PASZEK	DATE: 27.05.2019	DRW: TOMAS PASZEK	SCALE: 1:2	SHEET: 3/4	CONTRACT NO: 60-01252	PART NO: 10141-099-01	PROJECT: 10141-099-01
HOLE TO HOLE ±0.1mm	HOLE TO HOLE ±0.2mm	EDGE TO HOLE ±0.1mm	EDGE TO HOLE ±0.2mm	HOLE TO EDGE ±0.1mm	HOLE TO EDGE ±0.2mm	HOLE SIZE ±0.08mm	BEND ANGLE ±85 DEG	SEE TABLE				
ALL DIMENSIONS IN MILLIMETERS (DO NOT SCALE DRAWING) KISS 2U SHORT V3 CFL OUTLINE DRAWING 10141-099-01												

FRONT DOOR OPEN - RISER CARD

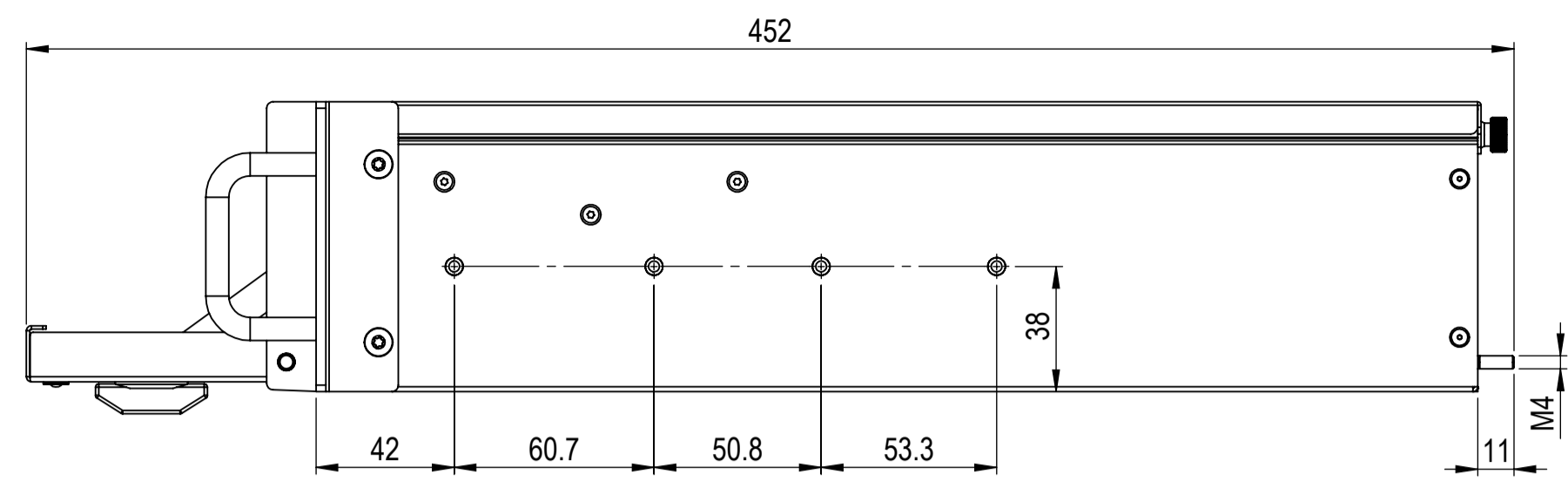

BACK VIEW

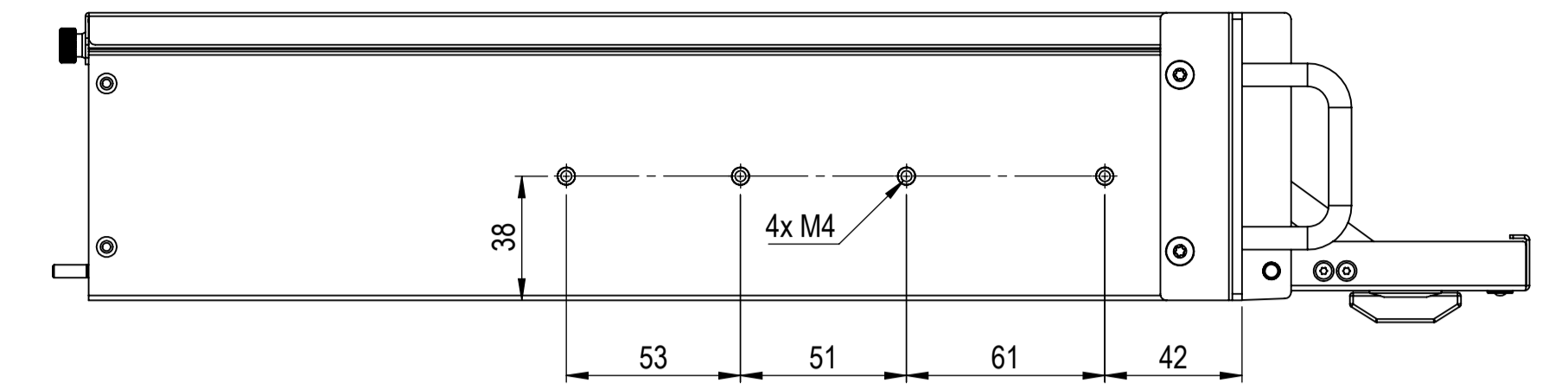
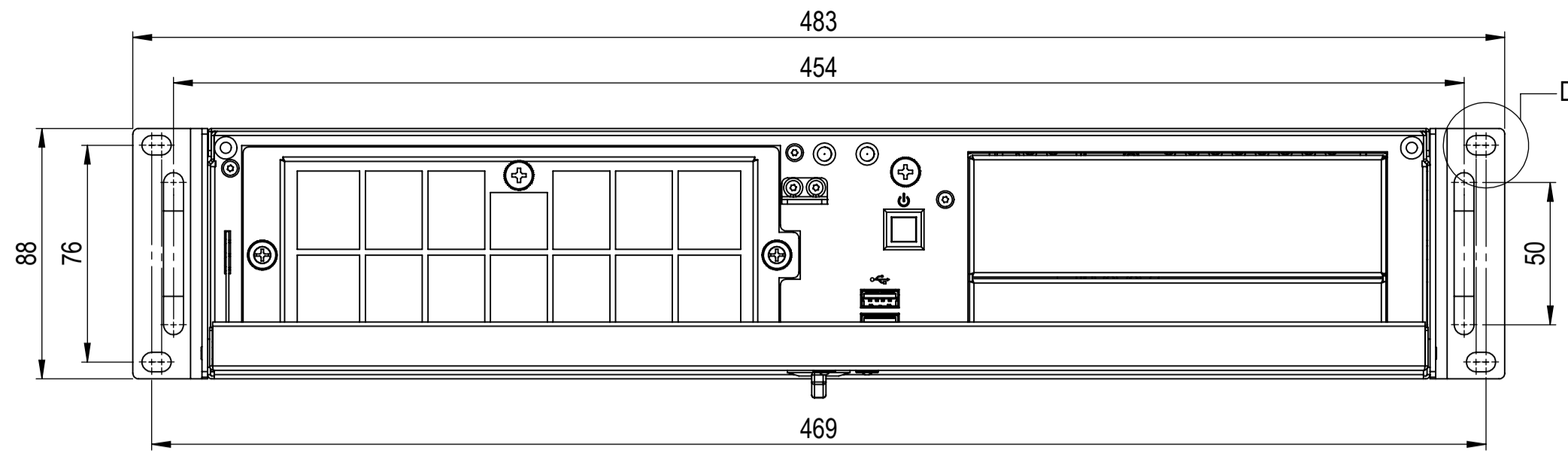

BOTTOM VIEW

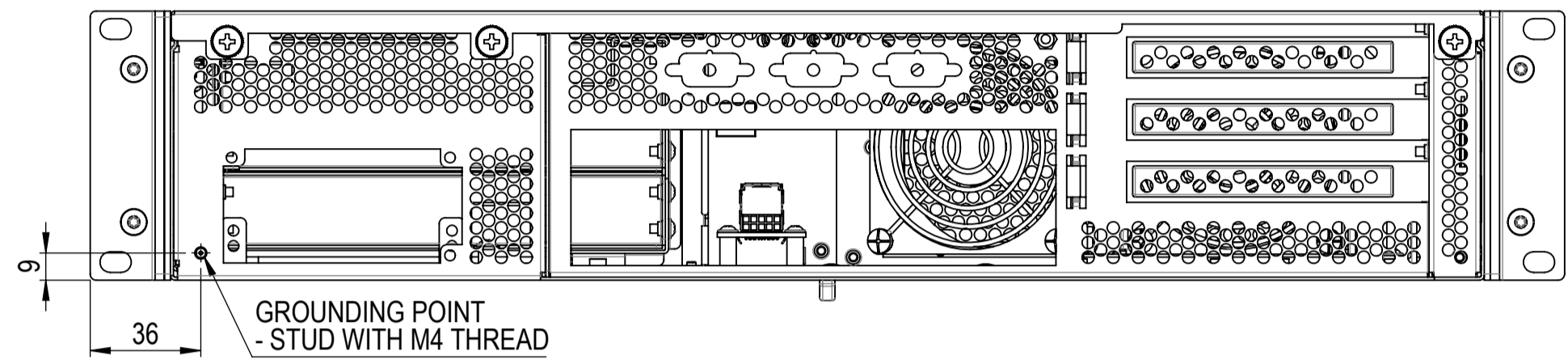

DETAIL D  
SCALE 2:1

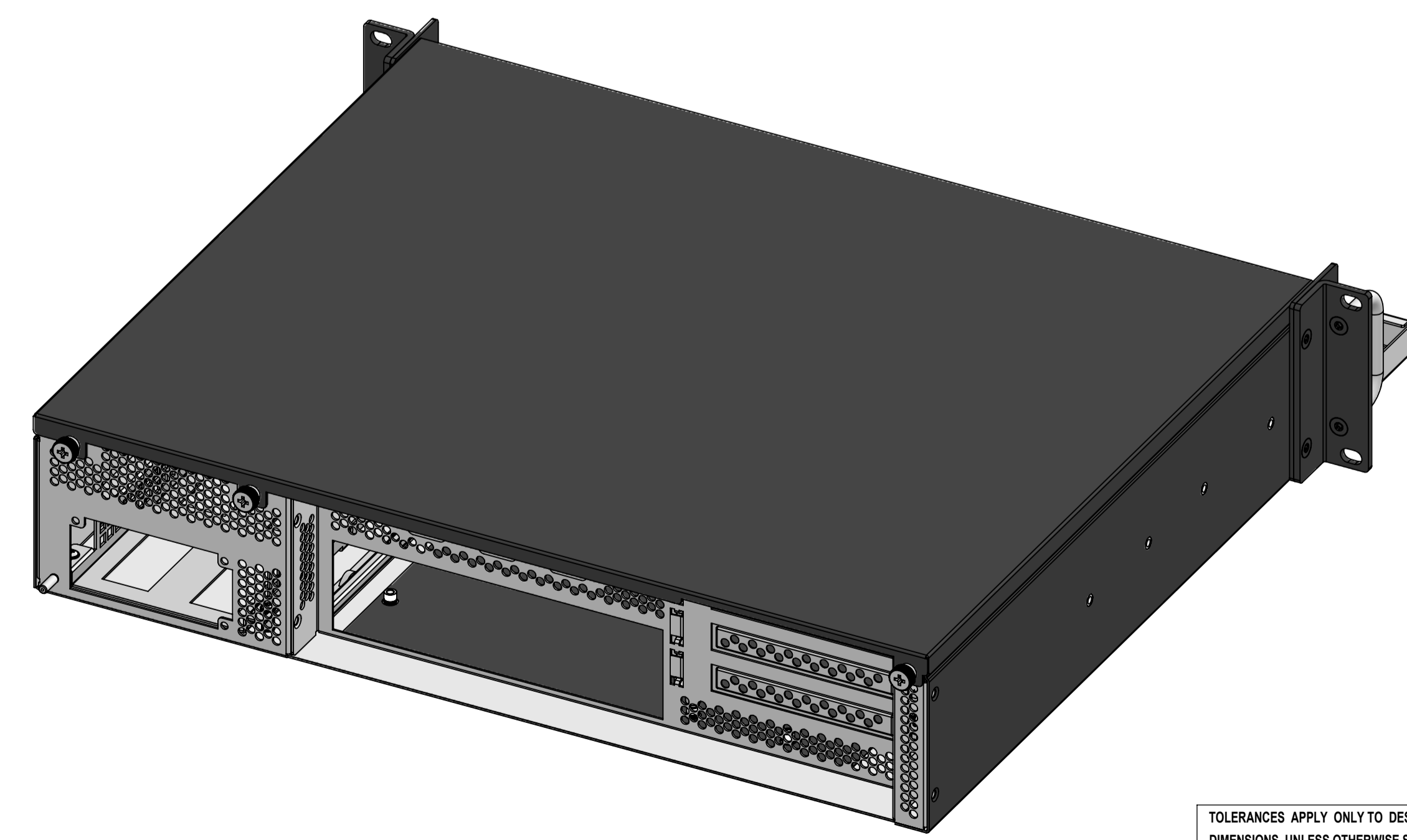
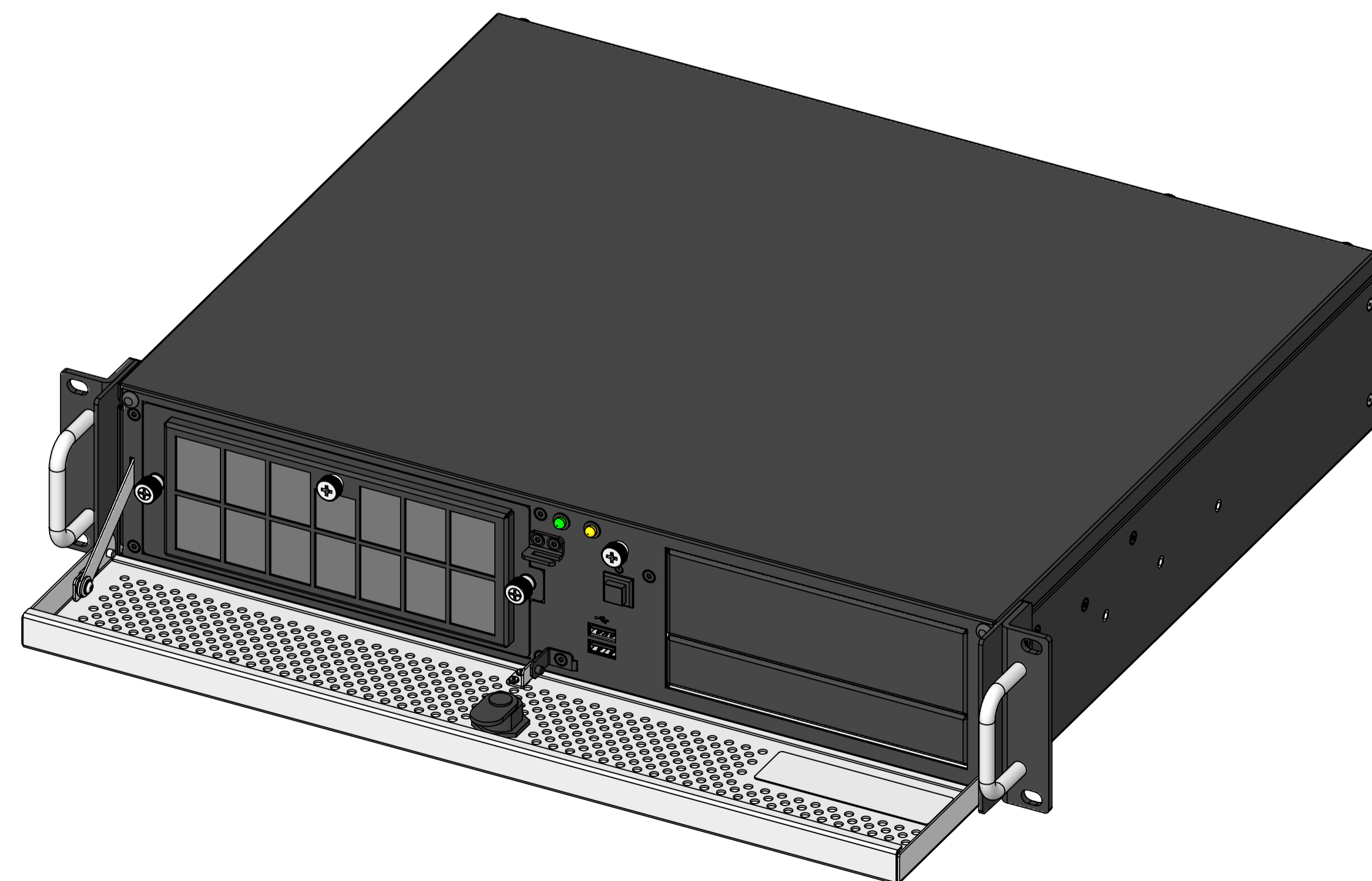
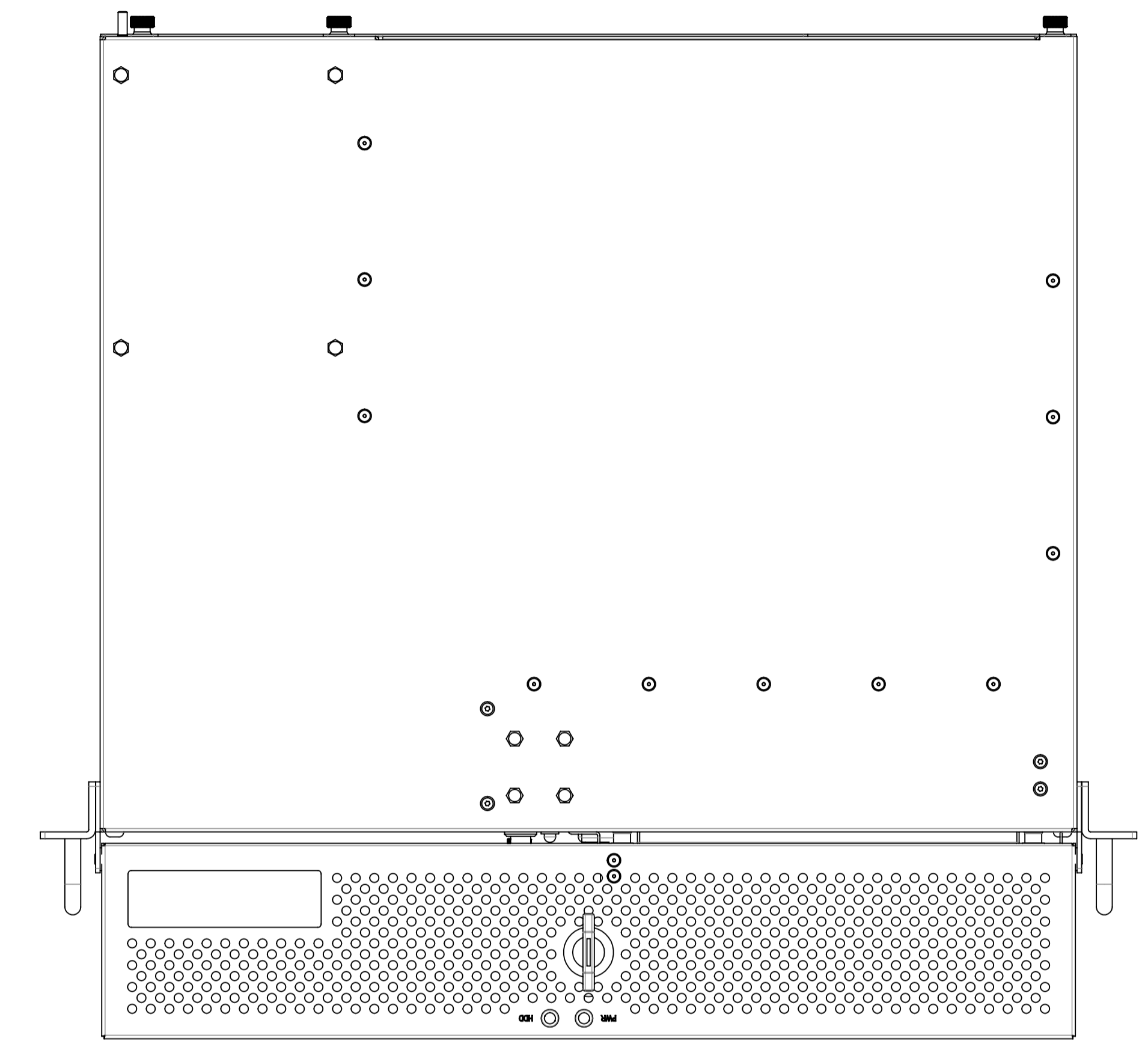
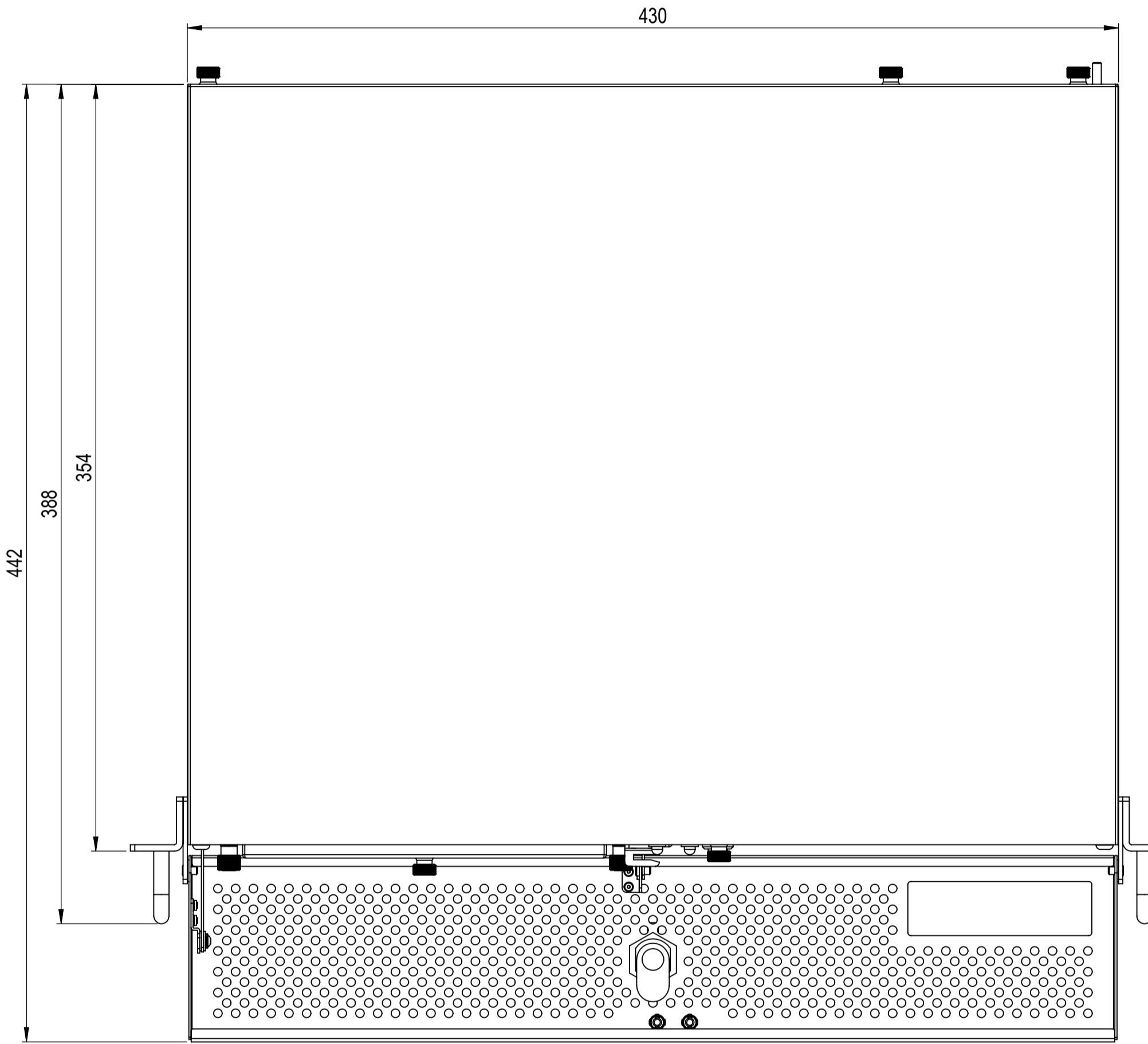
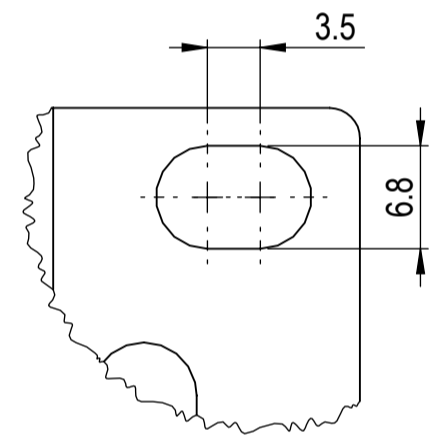

General:  
Undimensioned shape according to 3D model.  
Surface in visible area must be scratches free.  
Normal Handling should be free from risk of injury.  
Following specifications must be considered:  
- Technical Procurement Specification Mechanics  
- KISS 2U SHORT V3 Cosmetic Specification

TOLERANCES APPLY ONLY TO DESIGNATED DIMENSIONS, UNLESS OTHERWISE SPECIFIED:		DATE: 27.05.2019	DESIGNED BY: TOMAS PASZEK	DRWNO: 10141-099-01	PROJECT / CONTRACT NO: 60-01252
HOLE TO HOLE ±0.1mm	HOLE TO HOLE ±0.2mm	DATE: 27.05.2019	DRAWN BY: TOMAS PASZEK	MATERIAL/FINISH:	
EDGE TO HOLE ±0.1mm	EDGE TO HOLE ±0.2mm	DATE: 27.05.2019	APPROVED BY: TOMAS PASZEK	PART NAME: KISS 2U SHORT V3 CFL OUTLINE DRAWING	
EDGE TO EDGE ±0.2mm	EDGE TO EDGE ±0.2mm	DATE: 27.05.2019	DATE: 27.05.2019	CONTRACT NUMBER: 10141-099-01	
HOLE SIZE ±0.08mm	HOLE SIZE ±0.05 DEG	DATE: 27.05.2019	DATE: 27.05.2019	REVISION: A	

